



DENALI Plow Mount MA11741 Polaris Ranger Pro XP

Thank you for purchasing our DENALI plow mount. You now own a premium custom plow mount to allow you to use your plow with your SxS. Please note the following instructions and heed all warnings.

- Your UTV/SxS and/or plow system can cause death or injury, please use caution and common sense when operating your unit.
- Read your Plow Operator Manual, your Winch Operator Manual, and all warning labels before operating your UTV/SxS.
- Operate your UTV/SxS at a walking speed with the blade installed. Do not exceed 5 mph (8 km/h), even with the blade up.
- Do not operate the UTV/SxS on slopes greater than 10 degrees with the plow installed.
- Always lower the plow to the down position before leaving your UTV/SxS unattended.

SEVERE INJURY OR DEATH MAY RESULT IF YOU ARE NEGLIGENT.

Polaris Ranger Pro XP MA11741



22000 Industrial Blvd
Rogers, MN 55374
866.527.7637

Please verify that all hardware and parts are included in your package.

Kit Contents:

Item Number	Quantity	Part Number
1	1	MA11741-W1 Plow Mount
2	2	M12 x 1.75 x 75mm Flange Head Bolt
3	2	M12-1.75 Nylock Nut
4	2	M12 Flat Washer

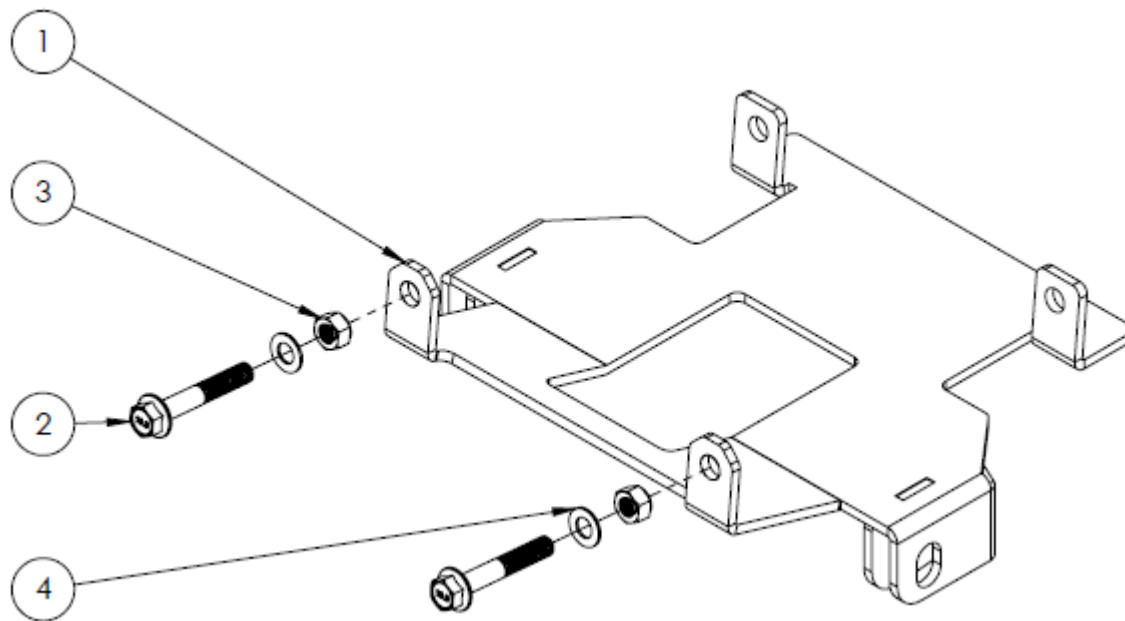

Figure 1

Polaris Ranger Pro XP Installation Instructions

1. Using a T40 torx bit remove the screws in the front facia and set aside facia and hardware to be reinstalled later.



Figure 2

2. Lift the front of the RZR. Make sure the front tires are completely off the ground.
NOTE: Lift from behind the A-Arms so that the plow mounting location is still available.



Figure 3

Polaris Ranger Pro XP MA11741



22000 Industrial Blvd
Rogers, MN 55374
866.527.7637

3. Remove the four M12 bolts securing the A-Arms as shown in Figure 4. The front two bolts will be replaced by the M12 hardware in your plow mount kit. The rear bolts will be reused.



Figure 4

4. Lift the mount into place and secure the front with the provided M12-1.75 x 75 and the back with the long bolts.



Figure 5

5. Reinstall the front fascia removed in Step 1 and verify that all hardware is tightened evenly.
6. Use the pins supplied with your DENALI Plow System to attach the plow to the mount.
7. Retighten all hardware after the first use, continue to retighten hardware seasonally.